



PHOTOS: MIKE BRESNEN, MIKE BRESNEN PHOTOGRAPHY, CINCINNATI, OH

# vintage elements, historical integrity

THE KITCHEN ADDITION HAD TO BE LIGHT, BRIGHT AND IN KEEPING WITH THE OLD NEIGHBORHOOD

## WISH LIST

- Booth near a window for family dining
- A lot of light through windows and skylights
- Wolf range

Because a couple loved the quaint character of their neighborhood in suburban Cincinnati, Ohio, they asked architect Ryan Duebber and builder Tim Howland to maintain that sensibility when adding onto the kitchen and bedroom. They wanted exterior materials and detailing to maintain the same style, and new rooms within to reflect the same vintage look. Yet, some renovations prove that a new space can be compatible to the original but have its own slightly different personality.

The kitchen's 12'-high vaulted ceiling, for example, is a major change from the home's other lower, flat ceilings; it has three large skylights that flood the room with sunlight. Instead of a traditional area for a breakfast table and chairs, the room contains a windowed booth, constructed from red oak with a walnut inlay, one of the wife's many ideas. And the longest work wall in the kitchen, where the range is, has subway tiles installed in a "scattered" pattern. "That also was the wife's idea for something that would be different," says Howland. Placing the range there let the team conceal an unappealing view of a neighboring house.

For continuity, cherry cabinets were finished in a white wash, and the same speckled tan granite was used both on perimeter countertops and the big 7½' x 5½' island. Island cabinets are black enamel that was distressed—a look that Howland says many clients seek. Distressing the cabinets made sense since the island would get hard use with children, he adds. The range is supplemented by double ovens and a microwave in a drawer on the island, near the booth. Mustard-colored walls and a light red-oak floor provide a cheerful shell. "We were able to marry new and old forms and not make the addition seem like a huge element added onto the back of the house," says Duebber. Adds Howland, "Providing a large and highly functional space while preserving the integrity of an old historic neighborhood was the best thing we did."



An L-shaped work arrangement and a symmetrical island stand in contrast to the scattered tile pattern.

ABOVE LEFT: A windowed booth for eating reflects the home's traditional style.

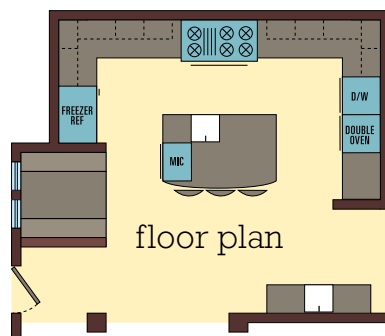

## DESIGNER:

Mark Korte  
Keidel Cabinetry & Appliances  
7930 Hosbrook Road  
Cincinnati, OH 45243  
513-984-9100  
keidel.com

## BUILDER:

Tim Z. Howland  
The Howland Group LLC  
17 Laurel Ave.  
South Milford, OH 45150  
513-340-4704  
howland-group.com

## ARCHITECT:

Ryan Duebber  
Ryan Duebber Architect LLC  
6050 Dryden Ave.  
Cincinnati, OH 45213  
513-351-5141  
rda-architecture.com

LOCATION: Cincinnati, OH

## DIMENSIONS: 18' x 20'

### >>> SPECIAL FEATURES:

Subway tiles in scattered pattern;  
Three skylights

### PRODUCTS USED:

- Range: 36" Wolf gas range top
- Hood: Zephyr, Savona
- Refrigerator/freezer, double

ovens, icemaker, beverage center: KitchenAid, Architect II Series

- Sink: Rohl 30" farmhouse-apron sink
- Countertops: Venetian Gold granite, Modlich Stoneworks, Cincinnati, OH
- Cabinetry: Rockglen, Woodlawn semi-custom cabinetry, Coastal White and Heritage Black with distressing
- Faucet: ShowHouse by Moen